

The British Research Institute for Disabled Consumers supplied this min-max seat edge height from the ground. The range of cars in the UK and NZ are similar. Generally heights go something like this (in metric):

450-550mm: Very sporty cars and sporty sedan.

550-600mm: Average sedans, estates - this used to be the norm historically, pretty much the height range you'll experience in something like a Toyota Camry.

600-650mm: Subcompacts, small cars - since designers have to cramp passengers into a smaller space, the seat is usually pushed up to accommodate for everyone and you actually sit higher in small cars than in larger models. It'll become obvious once you sit in a Honda Fit or Fiat 500.

One of the things we have found by experience is that often two door cars are easier to enter as the doors are longer and the door pillar is set further back than in a 4 door.

Also, courtesy of Road & Track Magazine Data Base, the following median seat heights list.

Sports Cars	414mm
Subcompact Cars	579mm
Compact Cars	515mm
Mid Sized Cars	528mm
Station Wagons	541mm
Subcompact SUV	653mm

The LOGO Lifter Mk 4B with the 200mm linear actuator option will operate over the 456 to 656 height range and covers a wide range of commonly available New Zealand vehicles.

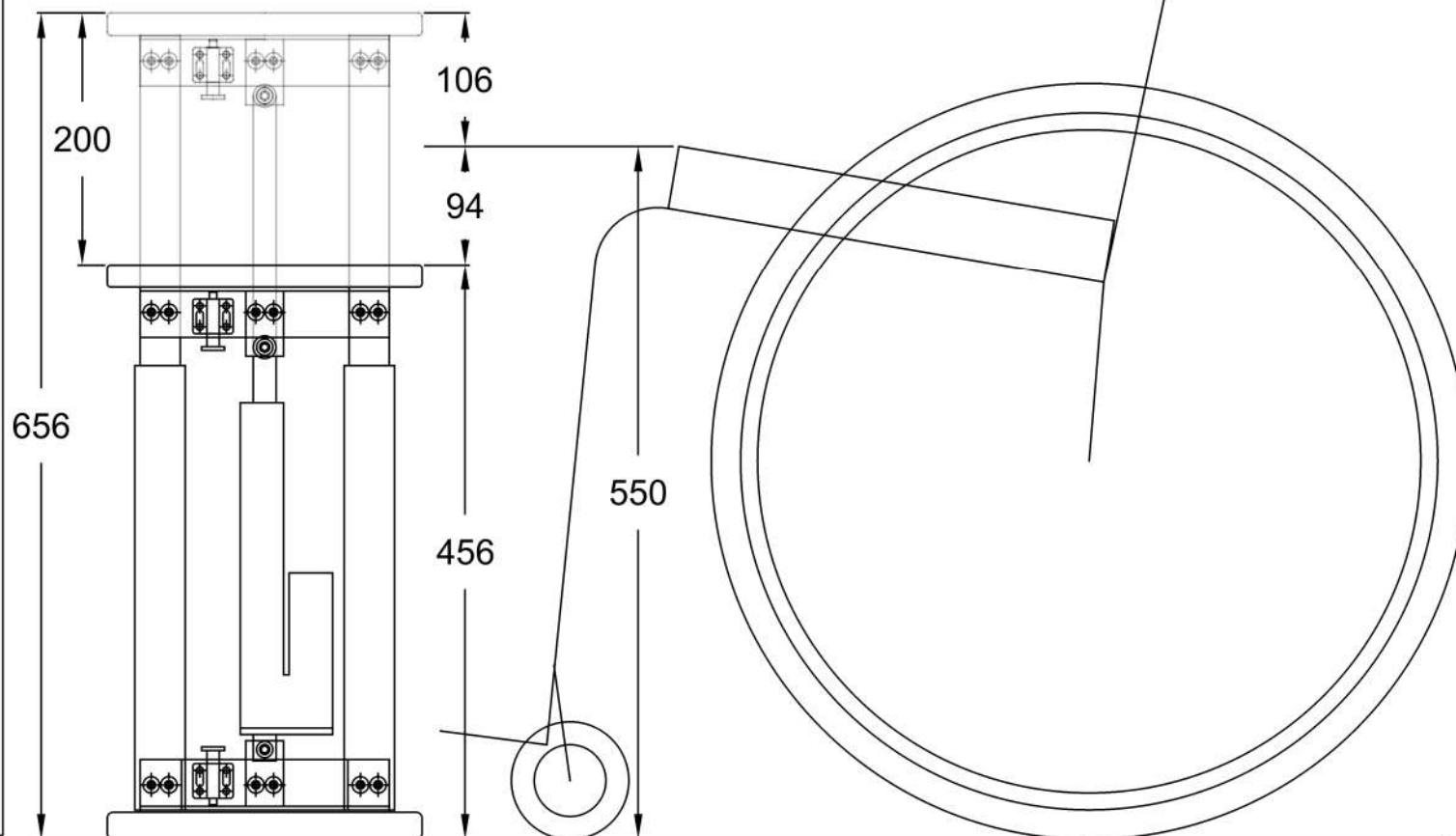

LOGO Lifter Mk 4 B

www.kiwilifters.nz

New Zealand Patent Application 808366 Max Load 120kg Made In New Zealand

www.kiwilifters.nz

info@kiwilifters.nz

0274 954 845

Kiwi Lifters New Zealand Limited

Information Bulletin July 2024